

# INSTRUCTION

50-2016



Flat Polymero

311947.002.1.76

IP 40 IK03 
 220 - 240 V / 50 - 60 Hz 
 LED 
 5 x 1,5 mm<sup>2</sup>
 2,50 mm<sup>2</sup>

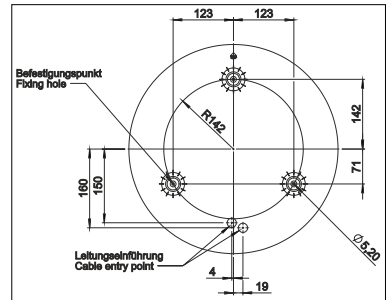
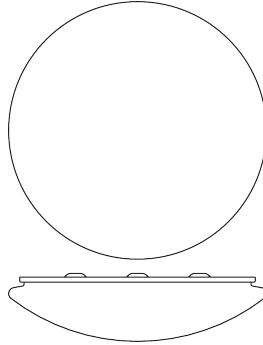

311947.002.1.76	D 460, H 120	LED	21 W	2,69 kg
$\Phi$	EEK <sub>LED</sub>	EEK	CRI	CCT
1950 lm	A+	A+	83	3000K
B10	B16	C10	C16	I max / I max/2 / T50
77	124	77	124	0,1 A



Die Leuchte darf nur mit ihren vollständigen Schutzabdeckungen betrieben werden.  
The luminaire must be used with its complete protective covers only.

EN 12464

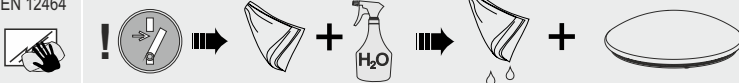

EN 12464

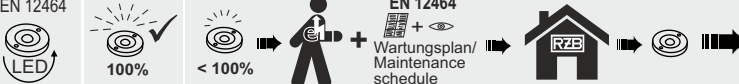

**RZB**  
**Rudolf Zimmermann,**  
**Bamberg GmbH**  
 Rheinstraße 16  
 D-96052 Bamberg  
 Deutschland  
 Telefon +49 951/79 09-0  
 Telefax +49 951/79 09-198  
 www.rzb.de  
 info@rzb-leuchten.de

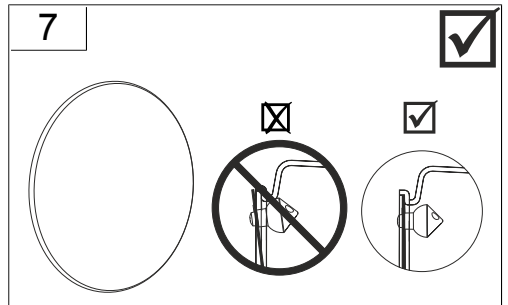
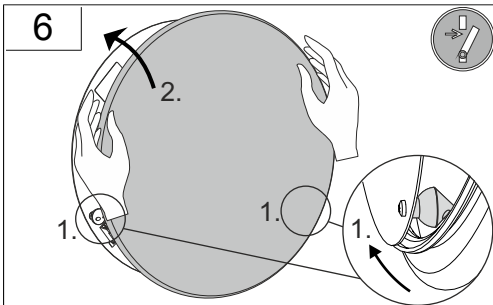
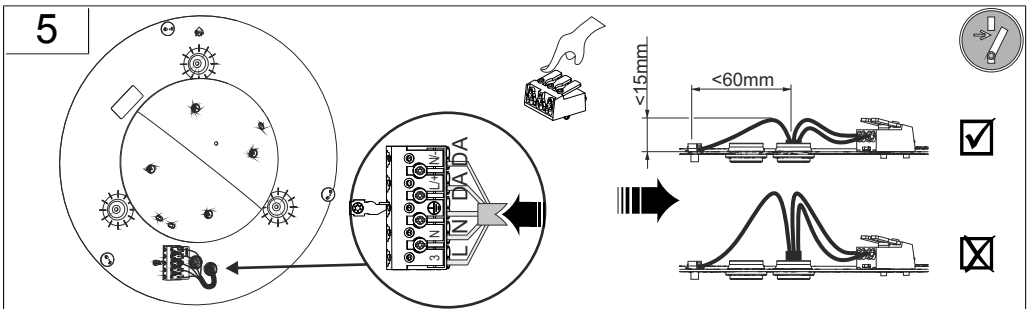
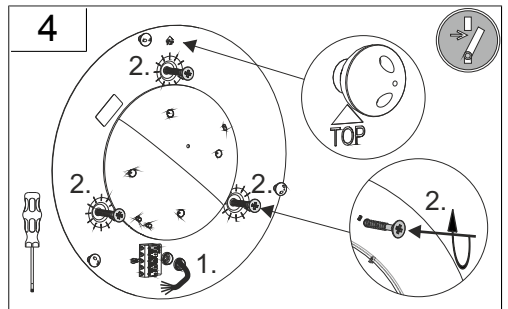
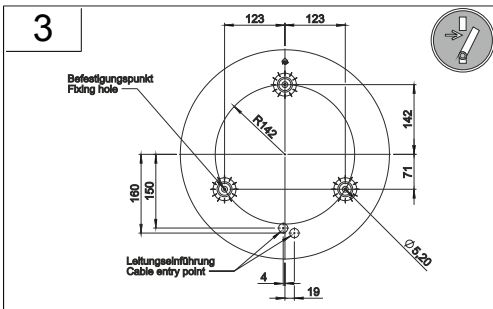
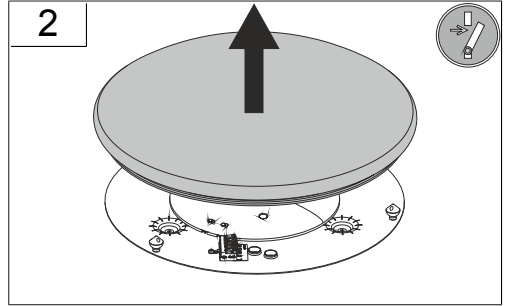
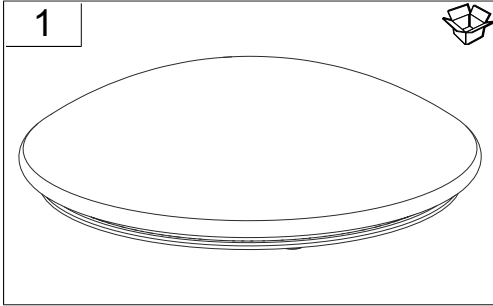



**a**

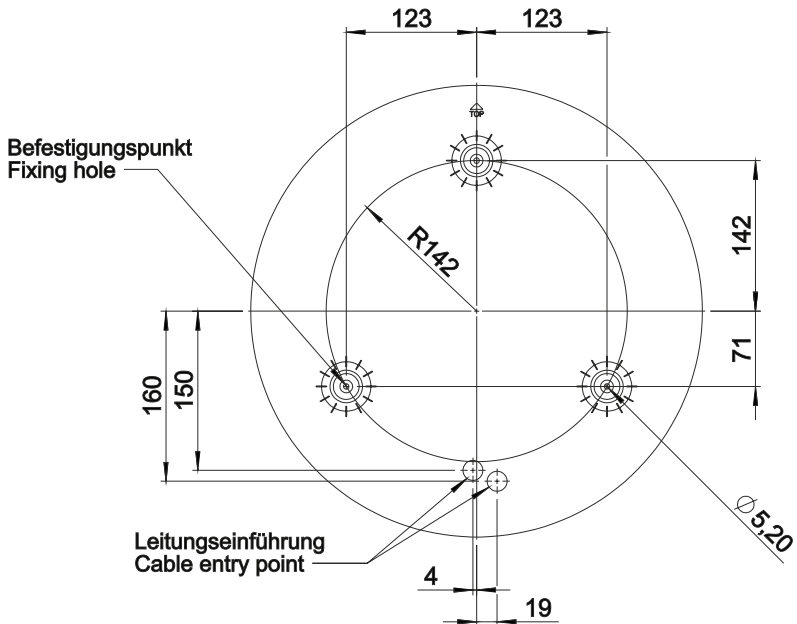











**b**

**DIN 4844**

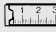

Vor Wartung oder Reparatur freischalten/  
power off before maintenance or repair

	 +		
	981805.002	D 490, H 19	426 g
	981805.004	D 490, H 19	426 g
	981805.0042	D 490, H 19	411 g

	 		
	08-311165.012	Ersatzdiffusor PMMA D 460	0,65 kg