

PERFECT Kabelverschraubung

50.6xx PAzzzzFK1

Hutmutter	Polyamid PA6 V-2
Dichteinsatz	TPE TPS
Zwischenstützen	Polyamid PA6 V-2
Anschlussgewinde	metrisch, nach EN 60423



Eigenschaften

	<ul style="list-style-type: none"> für abgerundete Flachkabel
Temperaturbereich	-20 °C / +100 °C (dynamisch) -40 °C (statisch, kurzzeitig)
Schutzart	IP66 bei genauer Übereinstimmung der Kabelaußenmaße mit den Schlitzmaßen C max. (Tabelle 1), IP54 im Bereich zwischen C max. und C min. (Tabelle 2)
Hinweis	Dichteinsätze - siehe unter Zubehör-Serie WJ-DM xxFK1

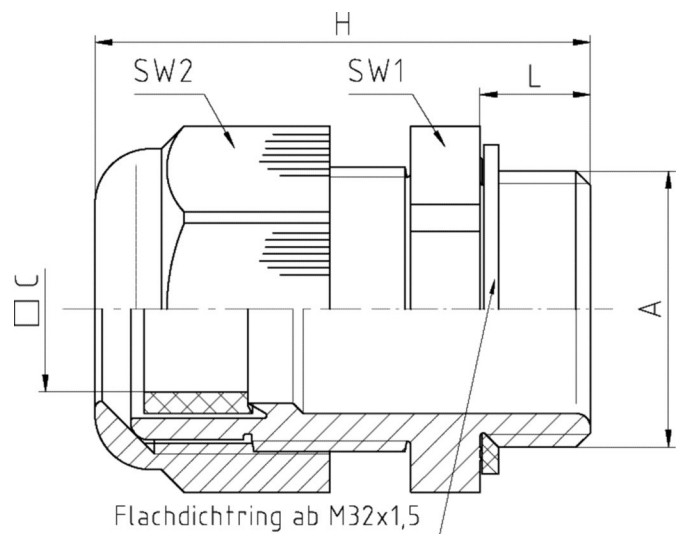

Merkmale



RAL 9005

maximaler Klemmbereich C max.

A	ØC	L	SW1	SW2	H	VPE	Art.-Nr.
M20x1,5	2x8 - 5x12	8	24	24	36	100	50.620 PASWFK1
M25x1,5	2x10 - 6x16,3	8	29	29	43	50	50.625 PASWFK1
M32x1,5	3x12 - 9x20	10	36	36	50	25	50.632 PASWFK1
M40x1,5	3x19 - 10x27	10	46	46	51	10	50.640 PASWFK1
M50x1,5	4x23 - 13x34	12	55	55	61,5	5	50.650 PASWFK1

A	ØC	L	SW1	SW2	H	 VPE	Art.-Nr.
---	----	---	-----	-----	---	---	----------

M63x1,5	6x32 - 15x45	12	68	68	65,5	5	50.663 PASWFK1
---------	-----------------	----	----	----	------	---	----------------

minimaler Klemmbereich C min.

A	ØC	L	SW1	SW2	H	 VPE	Art.-Nr.
---	----	---	-----	-----	---	---	----------

M20x1,5	2x8 - 5x12	8	24	24	36	100	50.620 PASWFK1
---------	---------------	---	----	----	----	-----	----------------

M25x1,5	2x10 - 6x16,3	8	29	29	43	50	50.625 PASWFK1
---------	------------------	---	----	----	----	----	----------------

M32x1,5	3x12 - 9x20	10	36	36	50	25	50.632 PASWFK1
---------	----------------	----	----	----	----	----	----------------

M40x1,5	3x19 - 10x27	10	46	46	51	10	50.640 PASWFK1
---------	-----------------	----	----	----	----	----	----------------

M50x1,5	4x23 - 13x34	12	55	55	61,5	5	50.650 PASWFK1
---------	-----------------	----	----	----	------	---	----------------

M63x1,5	6x32 - 15x45	12	68	68	65,5	5	50.663 PASWFK1
---------	-----------------	----	----	----	------	---	----------------



RAL 7035

maximaler Klemmbereich C max.

A	ØC	L	SW1	SW2	H	 VPE	Art.-Nr.
---	----	---	-----	-----	---	---	----------

M20x1,5	2x8 - 5x12	8	24	24	36	100	50.620 PA7035FK1
---------	---------------	---	----	----	----	-----	------------------

M25x1,5	2x10 - 6x16,3	8	29	29	43	50	50.625 PA7035FK1
---------	------------------	---	----	----	----	----	------------------

M32x1,5	3x12 - 9x20	10	36	36	50	25	50.632 PA7035FK1
---------	----------------	----	----	----	----	----	------------------

M40x1,5	3x19 - 10x27	10	46	46	51	10	50.640 PA7035FK1
---------	-----------------	----	----	----	----	----	------------------

M50x1,5	4x23 - 13x34	12	55	55	61,5	5	50.650 PA7035FK1
---------	-----------------	----	----	----	------	---	------------------

M63x1,5	6x32 - 15x45	12	68	68	65,5	5	50.663 PA7035FK1
---------	-----------------	----	----	----	------	---	------------------

minimaler Klemmbereich C min.

A	ØC	L	SW1	SW2	H	 VPE	Art.-Nr.
M20x1,5	2x8 - 5x12	8	24	24	36	100	50.620 PA7035FK1
M25x1,5	2x10 - 6x16,3	8	29	29	43	50	50.625 PA7035FK1
M32x1,5	3x12 - 9x20	10	36	36	50	25	50.632 PA7035FK1
M40x1,5	3x19 - 10x27	10	46	46	51	10	50.640 PA7035FK1
M50x1,5	4x23 - 13x34	12	55	55	61,5	5	50.650 PA7035FK1
M63x1,5	6x32 - 15x45	12	68	68	65,5	5	50.663 PA7035FK1





RAL 7001

maximaler Klemmbereich C max.

A	ØC	L	SW1	SW2	H	 VPE	Art.-Nr.
M20x1,5	2x8 - 5x12	8	24	24	36	100	50.620 PA7001FK1
M25x1,5	2x10 - 6x16,3	8	29	29	43	50	50.625 PA7001FK1
M32x1,5	3x12 - 9x20	10	36	36	50	25	50.632 PA7001FK1
M40x1,5	3x19 - 10x27	10	46	46	51	10	50.640 PA7001FK1
M50x1,5	4x23 - 13x34	12	55	55	61,5	5	50.650 PA7001FK1
M63x1,5	6x32 - 15x45	12	68	68	65,5	5	50.663 PA7001FK1

minimaler Klemmbereich C min.

A	ØC	L	SW1	SW2	H	 VPE	Art.-Nr.
M20x1,5	2x8 - 5x12	8	24	24	36	100	50.620 PA7001FK1

A	ØC	L	SW1	SW2	H	 VPE	Art.-Nr.
M25x1,5	2x10 - 6x16,3	8	29	29	43	50	50.625 PA7001FK1
M32x1,5	3x12 - 9x20	10	36	36	50	25	50.632 PA7001FK1
M40x1,5	3x19 - 10x27	10	46	46	51	10	50.640 PA7001FK1
M50x1,5	4x23 - 13x34	12	55	55	61,5	5	50.650 PA7001FK1
M63x1,5	6x32 - 15x45	12	68	68	65,5	5	50.663 PA7001FK1